

# MIAMI-DADE INTERMODAL CENTERS



**Making the Connection For You**



Miami-Dade Intermodal Centers



Kimley-Horn  
and Associates, Inc.

# STARTING THE PROCESS



## ◆ In-Depth Study Coordinated with Miami-Dade MPO:

- *Documented User Acceptance of Transfers*
- *Created Guidelines for Intermodal Center Development*
- *Identified 25 Potential Sites in Miami-Dade County*





# WHAT'S AN INTERMODAL CENTER?

- ◆ **A Connection Point Between Several Modes of Transportation**
- ◆ **A Safe, Convenient, and Pleasant Place to Transfer**
- ◆ **Serves as the “Front Door” to the Transportation Network**
- ◆ **A Public Service Effort Coordinated by Multiple Agencies**





# WHY ARE INTERMODAL CENTERS IMPORTANT?

- ◆ **Intermodal Centers Link Different Transportation Modes**
- ◆ **They Provide Incentive to Use a Variety of Transportation Modes**
- ◆ **Intermodal Centers Can Be a Community Focal Point**
- ◆ **Improves Image and Operations of Public Transportation**



# INTERMODAL CENTERS IN OTHER CITIES

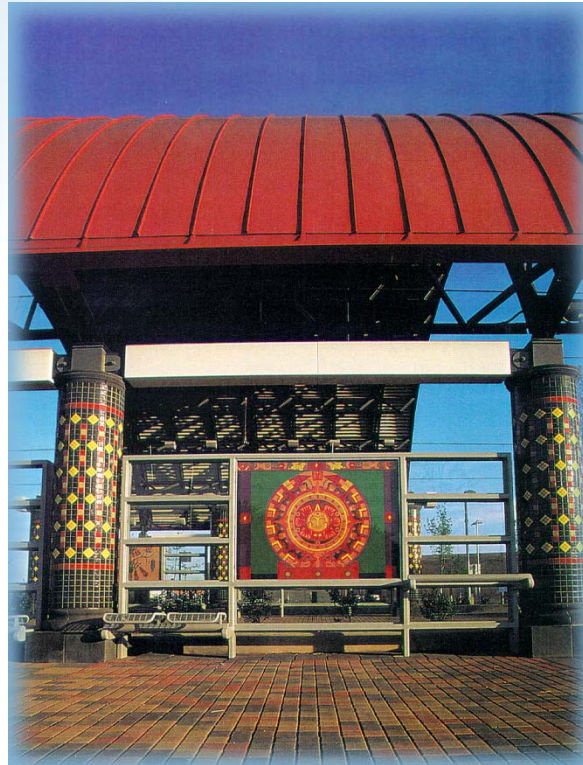

Similar Programs and Successful Results



# WHAT WILL THEY DO FOR MY COMMUNITY?

- ◆ **Improve Overall Transportation Operations**
- ◆ **Coordinate Schedules and Routes Between Metrobus, Metrorail, and Tri-Rail**
- ◆ **Link Taxis, Airport Shuttles, Cars, Water Taxis, Bicycles, and Pedestrians to Public Transportation**







# WHAT WILL THEY DO FOR MY COMMUNITY (CONT)

- ◆ **Provide Opportunities for Shops and Businesses to Serve the Traveling Public**
- ◆ **Increase MDTA Ridership and Revenue**
- ◆ **Enhance Aesthetic Value to the Community**



# INTERMODAL CENTERS IN OTHER CITIES

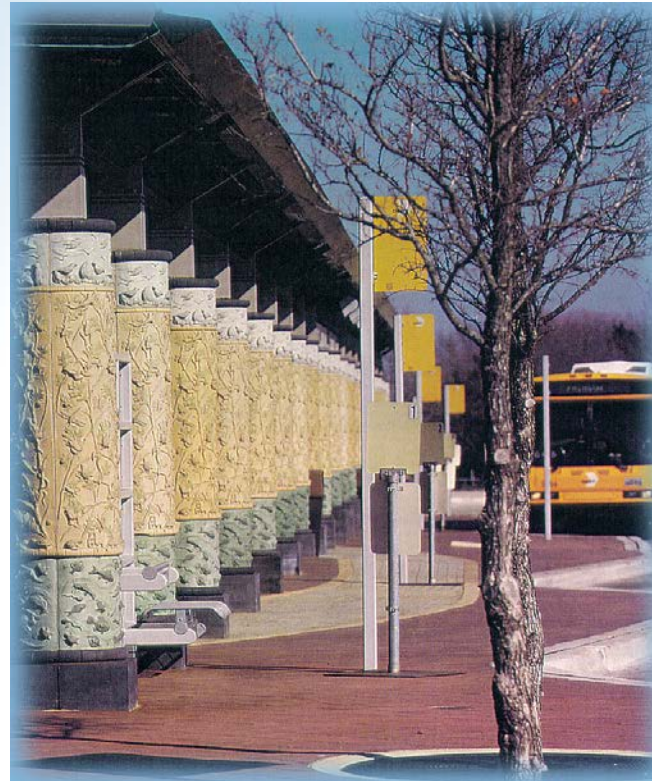

Intermodal Centers Can Be Safe and Pleasant



Miami-Dade Intermodal Centers



Kimley-Horn  
and Associates, Inc.



# MIAMI TRANSPORTATION POTENTIAL INTERMODAL CENTER SITE

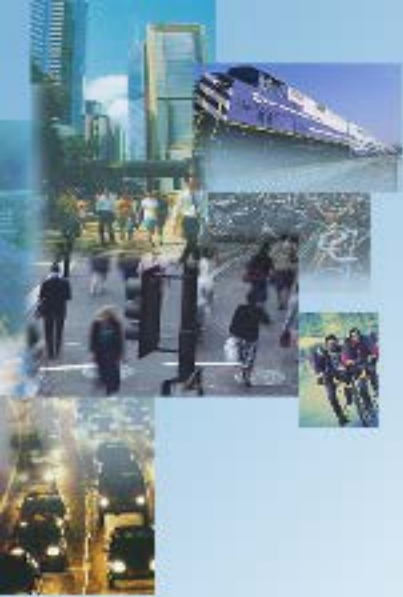

Existing Facilities at a Typical Bus Stop



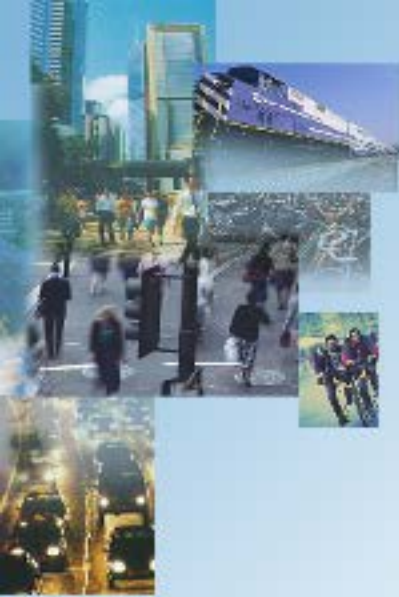

# INTERMODAL CENTER POTENTIAL SITE PLAN

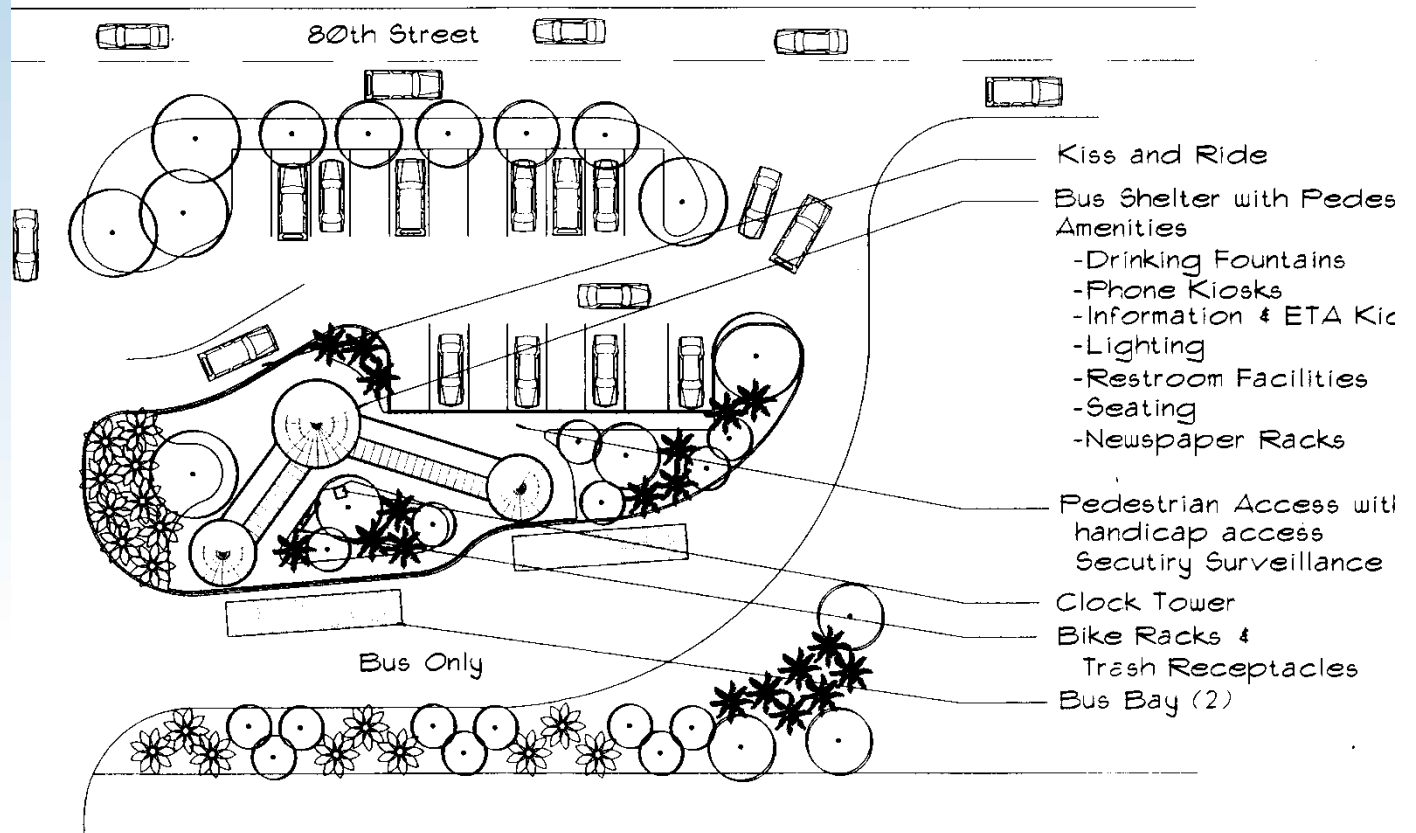

Bus Shelter, Phones, Drinking Fountains, Information Kiosks,  
and Restrooms are Potential Facilities



# WHAT'S THE PLAN?

## Short Range:

- ◆ **Obtain Funding Through State and Federal Grants**
- ◆ **Coordinate Location and Design with Community and Officials (TARC, CTAC, etc.)**
- ◆ **Involve Each Community in Design**
- ◆ **Open 25 Sites in Next 5 Years**





# WHAT'S THE PLAN?

## Long Range:

- ◆ **Identify and Implement 25 More Sites Over Next 10 Years**
- ◆ **Identify New Technology to Assist the Traveling Public at the Intermodal Centers**
- ◆ **Develop Policies to Create Transit-Oriented Communities**







# WHAT'S THE GOAL?

**To Improve Transportation Access  
and Operations for the Traveling  
Public in Miami-Dade County**



Miami-Dade Intermodal Centers



Kimley-Horn  
and Associates, Inc.