



# FDOT Transportation Alternatives Set-Aside Program

## FUNDING APPLICATION

Submittal Date:

### APPLICANT INFORMATION

<b>Agency/Organization Name:</b>			
<b>Agency Contact Name:</b>		<b>Title:</b>	
<b>Mailing Address:</b>		<b>City:</b>	<b>State: FL    Zip Code:</b>
<b>County:</b>		<b>MPO/TPO (if applicable):</b>	
<b>Telephone:</b>		<b>Email Address:</b>	

#### CERTIFICATION OF PROJECT SPONSOR/IMPLEMENTING AGENCY SUPPORT:

Certification of project sponsor/implementing agency support is attached.

Yes (Required)

**PROJECT TYPE:**  Infrastructure  Non-infrastructure

*FDOT requires locally administered infrastructure projects be implemented by a LAP certified agency; Non-infrastructure projects do not require LAP certification. If the project applicant intends to administer the project but is not LAP certified at the time of application submittal, they may seek project-specific certification prior to project authorization if their application is selected, or they may partner with a LAP certified agency or with FDOT to serve as the project sponsor and implementing agency. Non-profit organizations are not eligible for LAP certification.*

#### FOR INFRASTRUCTURE PROJECTS ONLY - APPLICANT'S LOCAL AGENCY PROGRAM (LAP) CERTIFICATION STATUS

- Currently fully LAP Certified / Year of Certification:
- Not LAP Certified but will seek project-specific certification
- Not LAP Certified but project will be administered by the FDOT District
- Not LAP Certified but have secured a LAP Sponsor/Implementing Agency as identified below:

<b>LAP Sponsor/Implementing Agency Name:</b>			
<b>LAP Sponsor/Implementing Agency Contact Name:</b>		<b>Title:</b>	
<b>Mailing Address:</b>		<b>City:</b>	<b>State: FL    Zip Code:</b>
<b>Telephone:</b>		<b>Email Address:</b>	

## PROJECT INFORMATION

### PROJECT NAME/TITLE:

### ELIGIBLE TRANSPORTATION ALTERNATIVES PROJECT CATEGORY:

Please check the one Transportation Alternatives eligible project category that the proposed project will address. Checking more than one category does not ensure or increase eligibility. Additional guidance on eligible project activities is included in Appendix B of the [FDOT TA Program Guidance](#).

1.  Construction, planning and design of on and off-road facilities for bicyclists, pedestrians, and other forms of nonmotorized transportation (pedestrian and bicycle facilities)
2.  Construction, planning and design of infrastructure-related projects/systems to provide safe routes for non-drivers including children, older adults, individuals with disabilities (safe routes for non-drivers)
3.  Conversion and use of abandoned railroad corridors for non-motorized use
4.  Construction of turnouts, overlooks, and viewing areas
5.  Inventory, control or removal of outdoor advertising
6.  Historic preservation and rehabilitation of historic transportation facilities
7.  Vegetation management practices in transportation rights of way
8.  Archaeological activities related to impacts from transportation projects
9.  Environmental mitigation activities
10.  Safe Routes to School

**\*NOTE:** Safe Routes to School (SRTS) funding under Transportation Alternatives is separate from the FDOT SRTS Program; however, if FDOT SRTS Program funds are to be used on any phase of the project then the project will need to comply with the Florida SRTS program requirements. For more information, visit <https://www.fdot.gov/safety/2A-Programs/Safe-Routes.shtm>.

### PROJECT LOCATION:

<b>Roadway name:*</b>		
<input type="checkbox"/> <b>On-State System Road</b> <small>(State Roadway)</small>	<input type="checkbox"/> <b>Off-State System Road</b> <small>(Local Roadway)</small>	<b>Roadway number:</b> <small>(i.e. US, SR, CR, etc., if applicable)</small>

**\*NOTE:** For off-road/trail projects please indicate adjacent roadway

### PROJECT LIMITS:

If project has various locations (e.g. city-wide), include attachments specifying each termini and project length.

<b>South or West Termini:</b> <small>Street Name/Mile Post/Other</small>	<b>North or East Termini:</b> <small>Street Name/Mile Post/Other</small>
<b>Project Length (in miles):</b>	
<b>Attachment included?</b> <input type="checkbox"/> Yes <input type="checkbox"/> No	
<b>A location map with aerial view is attached to this application.</b> <input type="checkbox"/> Yes (Required) <i>Label important features, roadways, etc. to clearly locate and show the boundaries of the project.</i>	

**PROJECT DESCRIPTION:**

**Brief Description (1,000 character limit)** (e.g. *planning, design and construction of a sidewalk along Sample Road*)

*Detailed Scope of Work:*

A detailed scope of work is attached.

Yes (Required)

*Clearly describe the existing conditions and the proposed project in detail, including specifics on the major items of work (e.g. width of sidewalks or trails, materials to be used, etc.), the purpose and need for this project, and the desired improvements.*

Conceptual or design plans are attached.

Yes  No

Typical Section drawings are attached.

Yes  No

Other attachment (e.g. studies, documentation to support the project).

Yes  No

If yes, please describe (250 character limit):

**PUBLIC INVOLVEMENT(500 character limit for each question below):**

**Has the applicant received input from stakeholders?** Briefly explain:

Yes  No

**Have public information or community meetings been held?**

Yes  No

If yes, please provide a brief description and attach supporting documentation:

**Describe public and private support for the project** (e.g. *petitions, endorsements, resolutions, letters of support*):

**Is the project within limits of wetlands, contamination/hazardous waste areas or endangered/threatened species?**

Yes  No

If Yes, specify and provide documentation:

**Is environmental permitting required?**

Yes  No

If Yes, specify and provide documentation:

**Provide any additional project specific information that should be considered:**

## PROJECT IMPLEMENTATION

**Please indicate the project phases included in this funding request:**

- Planning activities
- Project Development and Environment Study (PD&E)
- Preliminary Engineering/Final Design
- Right-of-Way (ROW)
- Construction
- Construction Engineering and Inspection activities (CEI)

**Please indicate who will execute the project phases identified for this project:\***

Planning	PD&E	Preliminary Engineering/ Final Design	ROW	Construction	CEI
<input type="checkbox"/> Implementing agency staff	N/A	<input type="checkbox"/> Implementing agency staff	N/A	<input type="checkbox"/> Implementing agency staff	<input type="checkbox"/> Implementing agency staff
<input type="checkbox"/> Consultant	<input type="checkbox"/> Consultant	<input type="checkbox"/> Consultant	<input type="checkbox"/> Consultant	<input type="checkbox"/> Consultant	<input type="checkbox"/> Consultant
<input type="checkbox"/> FDOT	<input type="checkbox"/> FDOT	<input type="checkbox"/> FDOT	<input type="checkbox"/> FDOT	<input type="checkbox"/> FDOT	<input type="checkbox"/> FDOT
<input type="checkbox"/> Not applicable	<input type="checkbox"/> Not applicable	<input type="checkbox"/> Not applicable	<input type="checkbox"/> Not applicable	<input type="checkbox"/> Not applicable	<input type="checkbox"/> Not applicable

**\*NOTE:** Local agencies are not eligible to be certified in PD&E and/or ROW (Refer to FDOT LAP Manual Chapters 11 and 12).

Is this project related to other FDOT funded phases that are complete, underway, or in FDOT's 5-year Work Program?

Yes  No

If Yes, please describe. If previous phases of this project were constructed as LAP projects, please provide the associated FDOT Project Number (i.e. FPID/FMN numbers) (500 character limit):

Is there a proposed maintenance plan for when the project is complete?  Yes  No

If yes, please provide a brief description and attach supporting documentation as appropriate (500 character limit):

## PROJECT RIGHT-OF-WAY / EASEMENT REQUIREMENTS

Is right-of-way acquisition proposed?  Yes  No

If yes, describe existing right-of-way (ROW) ownerships along the project, including when the ROW was obtained and how ownership is documented (i.e., plats, deeds, prescriptions, easements) (500 character limit). Attach ROW documentation as appropriate.

Also describe proposed acquisition including timeline, expected fund source, limitations on fund use or availability, and who will acquire and retain ownership of proposed right-of-way (500 character limit):

Will temporary construction easements be required?  Yes  No

If Yes, please describe (500 character limit):

## PROJECT COST ESTIMATE AND FUNDING REQUEST

### ESTIMATED PROJECT COST:

A detailed project cost estimate is attached.

Yes (Required)

*Provide a summary of the estimated cost for the work being proposed, indicating local fund allocation as appropriate.*

Project Phase	TA funds	Local funds	Total Cost
Planning Activities	\$	\$	\$
Project Development & Environmental Study (PD&E)	\$	\$	\$
Design Costs/Plan Preparation	\$	\$	\$
Environmental Assessment (s) associated with the design phase	\$	\$	\$
Permits associated with the design phase (including application fees, mitigation and permit acquisition work)	\$	\$	\$
Right-of-Way	\$	\$	\$
Construction	\$	\$	\$
Construction Engineering and Inspection Activities (CEI)	\$	\$	\$
Other costs* (please describe)	\$	\$	\$
<b>TOTAL ESTIMATED PROJECT COST</b>	<b>\$</b>	<b>\$</b>	<b>\$</b>
<b>PERCENT OF TOTAL PROJECT COST</b>			<b>100%</b>

*\*FDOT does not allow programming for contingency costs. Any contingency costs should be accounted for using local funds.*



**FLORIDA DEPARTMENT OF TRANSPORTATION DISTRICT VI**  
**2022 TRANSPORTATION ALTERNATIVES APPLICATION CYCLE**  
**FOR FISCAL YEAR 2027/2028**

**PROJECT IMPLEMENTATION**

**1. Design Plans**

- a. Are signed and sealed design plans available for this project?  Yes  No
- b. If yes, are design plans updated to current standards and existing conditions?  Yes  No
1. Specify the date of design plans developed? *Click here to enter text.*
2. Enter the Engineer of Record contact information: *Click here to enter text.*
- c. If no, identify status of design plans:
- No plans
- 30%
- 60%
- 90%
- Other Describe: *Click here to enter text.*

**2. Identify Permits & Certification Requirements**

Respond to applicable permits/ certifications within the project limits

- a) Right of Way Certification needs and status including easements  Yes  No  
*Click here to enter text.*
- b) Utility Certification  Yes  No  
*Click here to enter text.*
- c) Railroad Recertification  Yes  No  
*Click here to enter text.*
- d) South Florida Water Management District Permits  Yes  No  
*Click here to enter text.*
- e) U S Army Corps of Engineers (USACE) Permits  Yes  No  
*Click here to enter text.*
- f) Other Describe  Yes  No  
*Click here to enter text.*

**3. Acquired Permits/ Certifications are attached**

Yes  No

List:

**FLORIDA DEPARTMENT OF TRANSPORTATION DISTRICT VI**  
**2022 TRANSPORTATION ALTERNATIVES APPLICATION CYCLE**  
**FOR FISCAL YEAR 2027/2028**

The City made a request to the County to conduct a traffic study in light of traffic complaints in the area. As a result of the study, the County approved the roundabout. The City does not expect that there will be any delays in securing permits. The proposed roadway project will require the following five (5) permits:

1. Miami-Dade County – Regulatory and Environmental Resources (RER) – Stormwater
2. Miami-Dade County Department of Transportation & Public Works – Traffic Engineering Division
3. Miami-Dade County Fire Department
4. Tree Removal permit (only if required) with Miami-Dade County RER Tree Section
5. City of North Miami Beach Public Utilities



**FLORIDA DEPARTMENT OF TRANSPORTATION DISTRICT VI  
2022 TRANSPORTATION ALTERNATIVES APPLICATION CYCLE  
FOR FISCAL YEAR 2027/2028**

**PROJECT SCHEDULE**

**Include the following** *as applicable*

1. Consultant(s) acquisition & award (Design & CEI)
2. Contractor acquisition & award
3. Project schedule
4. Production dates
5. Plans preparation
6. FDOT Review submittal (30 days review)
7. Environmental Assessments
8. Permits Acquisition

**Enter project schedule here**

North Miami Beach NE 155th Street and NE 12th Avenue Roundabout (Traffic Calming)

Task	Start Date	End Date	Duration in Days
<b>Pre-Construction Phase</b>			
Procure Engineering Design Contractor	7/1/2026	8/31/2026	61
Public Outreach, Environmental Review, 30% Design	8/31/2026	12/30/2026	121
60% Design Complete	12/30/2026	3/29/2027	89
90% Design with Construction Documents Engineer’s Estimate of Probable Cost	3/29/2027	6/27/2027	90
100% Design Complete with Project Scope for Bid Documents	6/27/2027	9/26/2027	91
Permitting	9/26/2027	12/28/2027	93
<b>Construction Phase</b>			
Seek FDOT Approval of Construction Plans and Procurement Documents	12/28/2027	2/27/2028	61
Procure Construction Contractor	2/27/2028	8/24/2028	179
Construction Phase	8/24/2028	5/1/2029	250
Grant Closeout	5/1/2029	7/30/2029	90

**FLORIDA DEPARTMENT OF TRANSPORTATION DISTRICT VI**  
**2022 TRANSPORTATION ALTERNATIVES APPLICATION CYCLE**  
**FOR FISCAL YEAR 2027/2028**

**ENVIRONMENTAL EVALUATION**

Coordination with the Federal Highway Administration and the State Historic Preservation Officer will be required by Section 106 of the National Historic Preservation Act (NEPA)

**1. Has the Local Agency performed an environmental assessment for the project?**  Yes  No

List the environmental assessments performed: North Miami Beach will complete the environmental assessment during the design phase of the project.

**2. Does the Local Agency have a historic preservation planner?**  Yes  No

If yes, provide contact information: North Miami Beach does not have a historic preservation planner; however, the engineering team selected to design the project is required to assess the potential impact of all capital improvement projects on the City's historic properties.

**3. Is the project adjacent to a locally designated historic property or a National Register of Historic places-listed historic site?**  Yes  No

If yes, have any historic properties/places received Florida Department of State Historic Preservation Grant funds?

Yes  No

If yes, attach preservation agreements, covenants, or easements to this application.

**4. Are archeological sites or Native American sensitive sites located within proximity to or adjacent to the project?**  Yes  No

If yes, provide a brief description: [Click here to enter text.](#)

**5. Has the Local Agency coordinated with any Federal or State Agencies for this project?**  Yes  No

If yes, provide a brief description and submit supporting documentation: The project site is owned by Miami-Dade County. The City made a request to the County to conduct a traffic study in light of traffic complaints in the area. As a result of the study, the County approved the roundabout. If funded, the City will coordinate with FDOT to review and approve construction plans, meet federal environmental regulations, and review and approve procurement documents.

**6. Are parks, recreation areas or wildlife or waterfowl refuges adjacent or near the project?**  Yes  No

If yes, provide a brief description: [Click here to enter text.](#)

**7. Are there any navigable waterways adjacent or near the project?**  Yes  No

If yes, provide a brief description: [Click here to enter text.](#)

**8. Does the project have any wetland impacts?**  Yes  No

If yes, will wetlands mitigation be needed?

Yes  No

If yes, provide a brief description: [Click here to enter text.](#)

**9. Has the Local Agency reviewed the project for potential protected species/ critical habitat impacts?**  Yes  No

If yes, provide a brief description: The City does not expect that any protected species/critical habitats will be impacted by the project. During the design phase, a study of protected species such as the Florida bonneted bat will be conducted. The results of the environmental study will be shared with FDOT prior to the construction phase.

**FLORIDA DEPARTMENT OF TRANSPORTATION DISTRICT VI**  
**2022 TRANSPORTATION ALTERNATIVES APPLICATION CYCLE**  
**FOR FISCAL YEAR 2027/2028**

**10. Has the Local Agency reviewed the project for potential contamination that could affect the area?**  Yes  No

If yes, provide a brief description: The City does not expect that the project will be impacted by contaminants. This will be assessed and confirmed during the design phase. Any potential contamination will be mitigated following best practices.

**11. Are there noise sensitive areas?**  Yes  No

If yes, provide a brief description: The proposed project is in a residential area and therefore the selected vendor must comply with the City's Noise Ordinance #9-4.7 Noises from Building or Manufacturing; Time Restricted. (A) Generally. It shall be unlawful for any person engaged in any building, construction, manufacturing or fabricating business or occupation in the City, either as owner, agent, servant or employee, to make, cause, suffer or allow, in connection with the operation of such business, or occupation, any loud, intense or annoying noise between the hours of 8:00 p.m. and 7:00 a.m. of the following day, which noise causes annoyance to the public or disturbs the peace, quiet and rest of persons occupying or residing on property near enough thereto to be annoyed or discomforted by such noises. (B) Special Equipment. In addition to the restrictions in paragraph a. hereof, it shall be unlawful for any persons engaged in any building or construction business to perform any work in the City between the hours of 5:00 p.m. and 7:00 a.m. weekdays and 5:00 p.m. and 9:00 a.m. on Sundays, except by written permission of the City Building Inspector, then only in cases of emergency, with the following machinery: Bulldozers, pile drivers, steam shovels, pneumatic hammers, and/or other similar apparatus. (C) Weekend restrictions in residential districts. In addition to the restrictions in paragraphs a. and b. hereof, it shall be unlawful for any person to engage in any outdoor construction or building activities which generate any offensive noises that affect the peaceable enjoyment of the neighborhood in any residential district in the City between the hours of 7:00 p.m. and 9:00 a.m. on Saturdays, Sundays and legal holidays."

**FLORIDA DEPARTMENT OF TRANSPORTATION DISTRICT VI  
2022 TRANSPORTATION ALTERNATIVES APPLICATION CYCLE  
FOR FISCAL YEAR 2027/2028**

**PROJECT FUNDING**

TRANSPORTATION ALTERNATIVES FUNDS	\$ 600000
LOCAL FUNDS ALLOCATED	\$ 100000
<b>TOTAL PROJECT COST</b>	<b>\$ 700000</b>

PERCENTAGE OF TA FUNDS	86%
PERCENTAGE OF LOCAL CONTRIBUTION	14 %

Note: The percentage of local contribution indicated above will be greater than or equal to the local contribution to the final contract award.

Example A: A 20% local contribution is indicated for a construction project. The local agency was awarded \$1,000,000. The bid amount is \$1,000,000. The awarded amount would be reduced to \$800,000. The local agency would contribute \$200,000.

Example B: A 20% local contribution is indicated for a construction project. The local agency was awarded \$1,000,000. The bid amount is \$1,400,000. The awarded amount would remain \$1,000,000. The local agency would contribute \$400,000.

**1. Describe in detail funding types and commitment funds that will fund the project:**

The TAP funds will fund the construction elements, along with construction engineering and inspection activities, of the project. The local match will consist of general funds from the City of North Miami Beach, which will be utilized for the design and other pre-construction phase activities.

**2. Provide the funding year for each phase(s) of the project:**

Pre-Construction (Local Match): 2026-2027, Construction (TAP Funds): 2027-2028

**3. Submit a letter from the Local Agency's Budget Office committing Local Funds to the project.**

A copy of the letter is included with this application.

Yes  No

**FLORIDA DEPARTMENT OF TRANSPORTATION DISTRICT VI**  
**2022 TRANSPORTATION ALTERNATIVES APPLICATION CYCLE**  
**FOR FISCAL YEAR 2027/2028**

**FLORIDA DEPARTMENT OF TRANSPORTATION DISTRICT VI  
2022 TRANSPORTATION ALTERNATIVES APPLICATION CYCLE  
FOR FISCAL YEAR 2027/2028**

**LOCAL AGENCY BUDGET OFFICE COMMITMENT LETTER**

**Submit a letter from the Local Agency's Budget Office committing Local Funds to the project.**

**Agency must include this form as a cover for the letter.**

Please see the attached Budget Commitment Letter



*City of North Miami Beach, Florida*

---

*Finance Department*

February 18, 2022

Stacy Miller  
District VI Secretary  
Florida Department of Transportation  
1000 N.W. 111<sup>th</sup> Avenue  
Miami, Florida 33172

**Re: City of North Miami Beach - NE 155<sup>th</sup> Street and NE 12<sup>th</sup> Avenue Roundabout  
(Traffic Calming)**  
2022 Application Cycle – Transportation Alternatives Program

Dear Ms. Miller,

The City of North Miami Beach (the “City”) is pleased to join the Florida Department of Transportation (“FDOT”) in expanding our mobility options for our residents. The City is requesting \$600,000.00 in the 2022 Transportation Alternatives Program Application Cycle.

The proposed project will construct a roundabout at the intersection of NE 155<sup>th</sup> Street and NE 12<sup>th</sup> Avenue, which will provide traffic calming effects to improve pedestrian connectivity and motorist safety at the intersection and surrounding areas. The City commits a local match of \$100,000 and will continue to budget for operations and maintenance once grant funding has expired.

Funding for this project will become available on October 1, 2022. If you should have any questions of concerns, please feel free to contact Ms. Judeen Johnson, Public Works Director, at (305) 948-2925 or via email at [judeen.johnson@citynmb.com](mailto:judeen.johnson@citynmb.com).

Thank you,

Marcia Fennell  
Chief Financial Officer

**FLORIDA DEPARTMENT OF TRANSPORTATION DISTRICT VI**  
**2022 TRANSPORTATION ALTERNATIVES APPLICATION CYCLE**  
**FOR FISCAL YEAR 2027/2028**

**PROJECT SPONSORSHIP CERTIFICATION**

I hereby certify that the proposed project herein described is supported by City of North Miami Beach (Local Agency, county, state or federal agency, or tribal council) and that said entity will: (1) provide any required funding match; (2) enter into a maintenance agreement with the Florida Department of Transportation (FDOT); (3) comply with the Federal Uniform Relocation Assistance and Acquisition Policies Act for any Right of Way actions required for the project, (4) Comply with Local Agency Program Manual during all phases of the project, (5) comply with the NEPA process prior to construction, which may involve coordination with the State Historic and Preservation Office (SHPO) prior to construction, and (6) support other actions necessary to fully implement the proposed project.

I further certify that the estimated costs are reasonable and understand that City of North Miami Beach (Local Agency, county, state or federal agency, or tribal council) will bear all expenses in excess of the total cost of the project. Upon notification of project award, I further certify that the aforementioned entity will work with the FDOT to ensure the associated contracts are executed in the fiscal year programmed. Project deferrals are highly discouraged and are subject to fund availability.

**Name (please type or print):** Judeen Johnson

**Title:** Public Works Director

**Signature:** \_\_\_\_\_  

**Date:** 2/18/2022

Signature of person with budget authority  
(i.e., County Administrator, or Public Works Director)





## City of North Miami Beach

### NE 155<sup>th</sup> Street and NE 12<sup>th</sup> Avenue Roundabout (Traffic Calming)

#### Scope of Work

#### **Project Background**

The City of North Miami Beach is requesting \$600,000 in funding to install one traffic roundabout at the intersection of NE 12th Avenue and NE 155th Street. This project aims to provide traffic calming effects that will improve pedestrian connectivity and motorist safety at and in the area surrounding the Project Site, which has been the site of 14 traffic accidents over the past three years. NE 12th Avenue is a major thoroughfare connecting the cities of North Miami Beach and North Miami, with a traffic volume of over 8,000 vehicles per day through a residential community. In addition, the NE 155th Street corridor connects two additional collector roads, NE 14th Avenue and NE 10th Avenue.

The proposed traffic calming element furthers the City's goal of designing "Pedestrian First" roadways and is aligned with the national goal of eliminating deaths due to accidents on America's roadways. The project elements include the construction of one (1) roundabout, high emphasis crosswalks, ADA compliant detectible warning pads at each crosswalk, enhanced pedestrian signage, reduced speed signage, directional arrows.

#### **Scope of Work**

The City of North Miami Beach proposes the construction of a roundabout at the intersection of NE 155<sup>th</sup> Street and NE 12<sup>th</sup> Avenue. The traffic circle will improve the flow of traffic and enhance pedestrian facilities to include the following components:

- Project design and permitting
- Construct a new Traffic Roundabout with directional arrows
- Construct new High Emphasis Crosswalks
- Install new Detectable Warning Pads (ADA Improvements)
- Install enhanced Pedestrian signage (Crossing Signage)
- Install Reduced speed signage

#### **Advantages**

Advantages of the construction of a roundabout include:

- Reduced traffic speed (typically accommodates traffic speeds of 15-25 mph)
- Significantly reduces the severity of intersection collisions
- Increased opportunity for landscaping
- Reduces noise impacts from stop signs and vehicle acceleration



### **Project Readiness**

The City of North Miami Beach will fund and procure a consultant to provide all pre-construction services, including engineering, design, preparation of construction documents, preparation of bid documents, and permitting. The City expects to complete 60% of the design by March 2027 and is prepared to work collaboratively with FDOT to finalize the design and complete the permitting process by December 2027.

The City's local match will be used for the pre-construction expenses. The City is requesting TAP funding support for the project's construction and construction engineering and inspection components. The project will be complete by July 2029. If approved for funding, the City is prepared to move the project schedule up and begin design as early as the Fiscal Year 2023-24.

### **Roundabout**

A roundabout, such as the one proposed, is a circular raised island, which reduces the speed at approaches through an intersection. Traffic moves around the island in a counter-clockwise direction. Circulating vehicles have the right-of-way. Deflector islands are installed on the approaches.

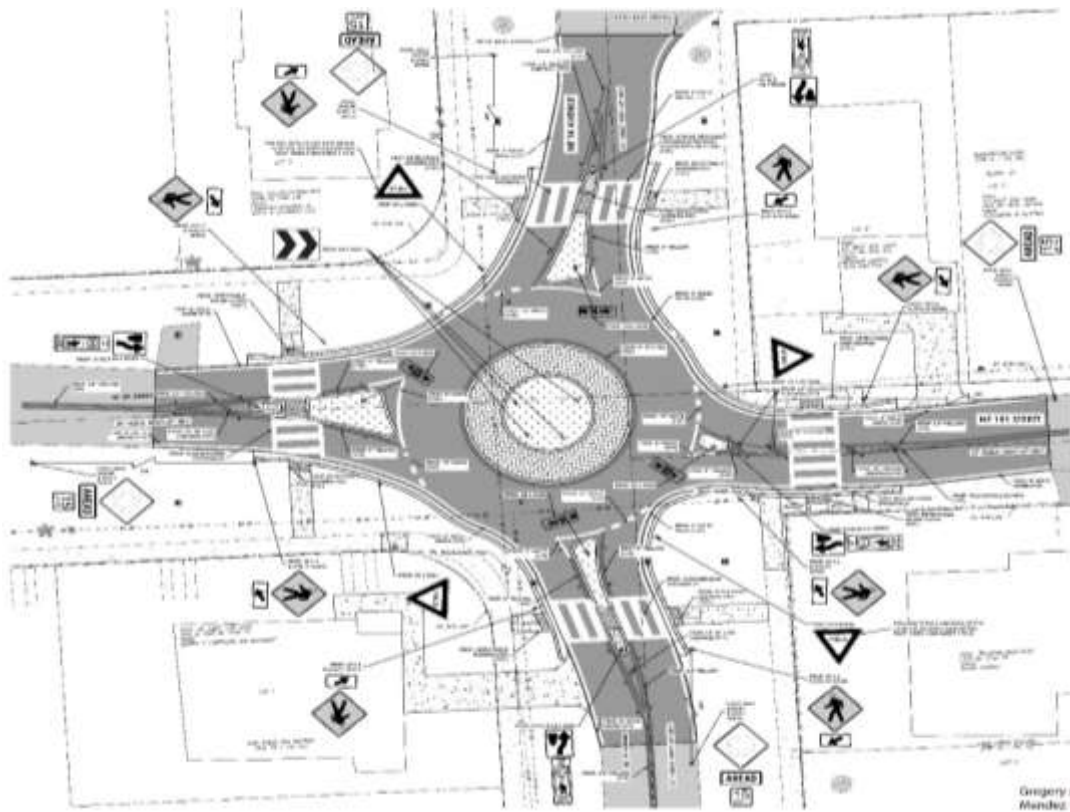

Email approving traffic circle at the intersection of NE 12<sup>th</sup> Avenue and NE 155<sup>th</sup> Street

**From:** Rodriguez, Doraida (DTPW) [<mailto:Doraida.Rodriguez@miamidade.gov>]  
**Sent:** Tuesday, March 05, 2019 12:54 PM  
**To:** Foy, David <[david.foy@nmbpd.org](mailto:david.foy@nmbpd.org)>  
**Cc:** Quartiano, Sheryl <[Sheryl.Quartiano@nmbpd.org](mailto:Sheryl.Quartiano@nmbpd.org)>; Assael, Jose <[Jose.Assael@nmbpd.org](mailto:Jose.Assael@nmbpd.org)>; Senespleda, Yamilet (DTPW) <[Yamilet.Senespleda@miamidade.gov](mailto:Yamilet.Senespleda@miamidade.gov)>; Eymil, Yelenys (DTPW) <[Yelenys.Eymil@miamidade.gov](mailto:Yelenys.Eymil@miamidade.gov)>; Johnson, Judeen <[Judeen.Johnson@citynmb.com](mailto:Judeen.Johnson@citynmb.com)>  
**Subject:** RE: Stop Sign traffic study NE 12 AV/151159 Street - SR 2018020532

Good afternoon,

The traffic study is concluded. As a result a multi-way stop controls are not recommend for the concerned corridor. For a multiway stop control to work the traffic volumes of the intersecting street must be balanced. NE 12 Avenue is a collector road that carries a traffic volume of more than 8000 vehicles per day while the intersecting roads have a daily volume of less than 800 vehicles per day. Please note that we took the traffic data at the intersection of NE 12 Avenue and NE 155 Street. The intersection is located at the midpoint of the corridor and it connects to NE 14 Avenues and NE 10 Avenues, both collector roads. **However, the corridor can benefit from a traffic circle at this intersection. The circle is as a traffic calming device and will improve the operational safety of the intersection. I'm copying Ms. Judeen Johnson from the City of North Miami Beach Public Works Department for her consideration. Please note that this email may serve as the operational approval for the installation of the traffic circle, no additional traffic study is required.** Should the City would like to proceed with the project, a permit must be obtain through our Construction Division on the 14<sup>th</sup> floor.

Should you have any questions or need additional information, please contact our office. Thanks,

**Doraida Rodriguez, M.S., P.E., PTOE, LEED A.P.**

Miami-Dade Department of Transportation and Public Works  
111 NW 1st Street • Suite 1510 • Miami, Florida 33128-1970  
305-375-1139 Phone  
305 375-6064 Fax  
[doraida@miamidade.gov](mailto:doraida@miamidade.gov)

**RESOLUTION NO. R2020-01**

**A RESOLUTION OF THE MAYOR AND CITY COMMISSION OF THE CITY OF NORTH MIAMI BEACH, FLORIDA, APPROVING THE ADOPTION OF THE NORTH MIAMI BEACH TRANSPORTATION MASTER PLAN; AND PROVIDING FOR AN Efective DATE.**

**WHEREAS**, the City of North Miami Beach (“City”) finds that in order to maintain and improve the health, safety, and welfare of the City, it is necessary to improve on the transportation services within its City; and

**WHEREAS**, the City Manager’s office, Public Works and Planning and Zoning Departments, with the assistance of professionals from the consulting firm, Kimley Horn & Associates engaged in a process to create and implement a Transportation Master Plan to sustain and improve transportation within the City; and

**WHEREAS**, the development of the Transportation Master Plan included literature research and review, data collection, analyses, planning –level design, preliminary cost estimating and interagency coordination; and

**WHEREAS**, the City participated in three working group meetings with staff, one inter-agency coordination meeting and one Commission workshop to assist in the development of the overall Master Plan; and

**WHEREAS**, Transportation Master Plan (attached hereto as Exhibit “A” and, by this reference, incorporated herein) includes the establishment of objectives, priorities recommendations to address roadway corridors, transit, intersection capacity and operational conditions and neighborhood traffic calming; and

**WHEREAS**, the Mayor and City Commission find it to be in the best interests of the City to adopt and implement the objectives and priorities set forth in the Transportation Master Plan and authorize the City Manager or designee to act in accordance with the plan.

**NOW, THEREFORE, BE IT RESOLVED** by the Mayor and City Commission of the City of North Miami Beach, Florida.

**Section 1.** The aforementioned recitals are true and correct.

**Section 2.** The Mayor and City Commission hereby authorize the City Manager or designee, to adopt the Transportation Master Plan (Exhibit “A”) for the purpose of improving transportation within the City.

**Section 3.** This resolution shall take effect immediately upon approval.

**APPROVED AND ADOPTED** by the City of North Miami Beach City Commission at the regular meeting assembled this **21<sup>st</sup> day of January 2020.**

ATTEST:



ANDRISE BERNARD, CMC  
CITY CLERK

(CITY SEAL)



ANTHONY F. DEFILLIPO  
MAYOR

APPROVED AS TO FORM, LANGUAGE  
AND FOR EXECUTION

  
SARAH L. JOHNSTON  
CITY ATTORNEY

Sponsored by: Mayor and City Commission

## EXHIBIT A



# City of North Miami Beach

TRANSPORTATION MASTER PLAN  
October 2019





The following Miami-Dade County/City maintained study segments are not expected to operate at or above their adopted LOS standards:

- NE 12<sup>th</sup> Avenue between NE 155<sup>th</sup> Street and NE 154<sup>th</sup> Street during daily
- NE 159<sup>th</sup> Street west of NE 13<sup>th</sup> Avenue during daily and the P.M. peak hour
- NE 18<sup>th</sup> Avenue north of NE 154<sup>th</sup> Terrace during daily
- W Dixie Highway south of NE 170<sup>th</sup> Street during daily and the P.M. peak hour
- NE 19<sup>th</sup> Avenue south of NE 179<sup>th</sup> Street during daily and P.M. peak hour
- NE 15<sup>th</sup> Avenue south of NE 176<sup>th</sup> Street during daily and P.M. peak hour

A GIS map illustrating the LOS results for the P.M. peak hour is include on **Exhibit F-1** in **Appendix F**.

**Table 5: Miami-Dade County/City Maintained Study Segments – Future (2040) Conditions Capacity Analysis**

Street Name	Location	Future 2040 Volumes		LOS Standard	Daily LOS	Daily LOS Standard Met?	Peak Hour LOS	Hourly LOS Standard Met?
		Daily	Peak Hour					
NE 10 <sup>th</sup> Avenue	South of NE 160 <sup>th</sup> Terrace	9,254	761	E+20	D	Yes	D	Yes
NE 12 <sup>th</sup> Avenue	Between NE 155 <sup>th</sup> Street & NE 154 <sup>th</sup> Street	15,593	1,237	E	F (E+11)	No	E	Yes
NE 159 <sup>th</sup> Street	West of NE 13 <sup>th</sup> Avenue	31,137	2,418	E+20	F (E+122)	No	F (E+91)	No
NE 14 <sup>th</sup> Avenue	South of NE 154 <sup>th</sup> Terrace	7,692	600	D	D	Yes	D	Yes
NE 16 <sup>th</sup> Avenue	North of NE 154 <sup>th</sup> Terrace	10,925	869	E	E	Yes	D	Yes
NE 18 <sup>th</sup> Avenue	North of NE 154 <sup>th</sup> Terrace	11,348	954	D	F (D+6)	No	D	Yes
NE 159 <sup>th</sup> Street	Between NE 18 <sup>th</sup> Place & NE 19 <sup>th</sup> Court	12,339	1,080	E	D	Yes	D	Yes
NE 167 <sup>th</sup> Street	Between 20 <sup>th</sup> Avenue & NE 21 <sup>st</sup> Avenue	3,075	244	D	C	Yes	C	Yes
NE 164 <sup>th</sup> Street	Between 20 <sup>th</sup> Avenue & NE 21 <sup>st</sup> Avenue	5,432	459	D	C	Yes	C	Yes
W Dixie Highway	South of NE 170 <sup>th</sup> Street	25,181	2,058	E+50	F (E+79)	No	F (E+62)	No
NE 171 <sup>st</sup> Street	West of NE 18 <sup>th</sup> Avenue	6,138	589	D	C	Yes	C	Yes
NE 15 <sup>th</sup> Avenue	South of NE 165 <sup>th</sup> Street	20,142	1,423	D	D	Yes	D	Yes
NE 151 <sup>st</sup> Street	Between NE 14 <sup>th</sup> Avenue & NE 13 <sup>th</sup> Avenue	2,183	272	E	C	Yes	C	Yes
Highlands Drive	East of NE 20 <sup>th</sup> Court	1,707	140	D	C	Yes	C	Yes
NE 35 <sup>th</sup> Avenue	North of NE 163 <sup>rd</sup> Street	22,150	1,637	D	D	Yes	D	Yes
NE 35 <sup>th</sup> Avenue	North of NE 167 <sup>th</sup> Street	9,323	663	D	C	Yes	C	Yes
NE 19 <sup>th</sup> Avenue	South of NE 179 <sup>th</sup> Street	36,483	2,941	D	F (D+25)	No	F (D+12)	No
NE 22 <sup>nd</sup> Avenue	Between NE 171 <sup>st</sup> Street & NE 170 <sup>th</sup> Street	3,426	270	D	C	Yes	C	Yes
N Miami Avenue	North of NW 170 <sup>th</sup> Street	2,847	227	D	C	Yes	C	Yes
NE 10 <sup>th</sup> Avenue	North of NE 179 <sup>th</sup> Street	11,123	978	E+20	E	Yes	E	Yes
NE 13 <sup>th</sup> Avenue	Between NE 179 <sup>th</sup> Street & NE 180 <sup>th</sup> Street	484	47	D	C	Yes	C	Yes
NE 15 <sup>th</sup> Avenue	South of NE 176 <sup>th</sup> Street	18,029	1,331	D	F (E+35)	No	F (E+11)	No
NE 167 <sup>th</sup> Street	Between NE 11 <sup>th</sup> Avenue & NE 12 <sup>th</sup> Avenue	9,626	760	D	D	Yes	D	Yes
NE 171 <sup>st</sup> Street	West of NE 4 <sup>th</sup> Court	2,408	236	D	C	Yes	C	Yes
NE 17 <sup>th</sup> Avenue	North of NE 176 <sup>th</sup> Street	398	78	D	C	Yes	C	Yes
NE 182 <sup>nd</sup> Street	Between NE 15 <sup>th</sup> Avenue & NE 16 <sup>th</sup> Avenue	1,611	175	D	C	Yes	C	Yes
NE 20 <sup>th</sup> Avenue	Between NE 175 <sup>th</sup> Street & NE 176 <sup>th</sup> Street	2,110	250	D	C	Yes	C	Yes
NE 182 <sup>nd</sup> Street	East of NE 21 <sup>st</sup> Avenue	477	65	D	C	Yes	C	Yes
NE 2 <sup>nd</sup> Avenue	Between NE 170 <sup>th</sup> Street & NE 169 <sup>th</sup> Terrace	5,417	438	E	D	Yes	C	Yes







FW: 12th Ave thoroughfare needs permanent speed deterrents

Regards,

**Judeen Johnson** | *Director*  
City of North Miami Beach  
Public Works Department  
**T** (305) 948-2925  
**F** (305) 957-3502

---

**From:** M Kazan [mailto:mikazan@msn.com]  
**Sent:** Monday, June 4, 2018 7:40 AM  
**To:** Scott, Esmond <Esmond.Scott@citynmb.com>  
**Cc:** Garcia, Ana <Ana.Garcia@citynmb.com>; NMBMGR <NMBMGR@citynmb.com>; Sosa-Cruz, Candido <Candido.Sosa-Cruz@citynmb.com>; Prescott, Kevin <Kevin.Prescott@nmbpd.org>; Hernandez, William <William.Hernandez@nmbpd.org>; Johnson, Judeen <Judeen.Johnson@citynmb.com>; Rodriguez, Fernando <Fernando.Rodriguez@citynmb.com>; M Kazan <mikazan@msn.com>  
**Subject:** Re: 12th Ave thoroughfare needs permanent speed deterrents

Dear Mr. Scott,

We residents would be grateful for a positive outcome of appropriate, permanent traffic calming devices installed.

Advise to Team City NMB: arm yourselves with the statistics of the crashes that have occurred along 12th Avenue, between 159th St and 151st St. over a two year period, compared to another section with traffic calming devices, and present this to whichever authority is responsible. I am sure many accidents occurred. Last night I witnessed the aftermath of another, at the same location...NE 12th Ave and 155 st. Most times I am not at home. The accidents I missed are most likely numerous. Please see the time dated snapshot below and the attached picture.

**NO TRAFFIC LIGHTS NEEDED**

I would strongly advise AGAINST placing traffic lights anywhere along this stretch. "Orange traffic light" to many means, "speed up". Green traffic light means, "speed up to catch the light". So this would definitely not reduce speeding.

While the explanations remain the same for several years now, nothing gets done permanently; lives are disrupted; it is a safety issue and insurance rates for the people in my community remain sky high due to the prevalent accidents that occur in our vicinity. For the last dozen years or so, without an accident, I managed to have a reduction of \$5.00 on my insurance premiums. It always goes up, never comes down.

I thank you for your time and consideration. Please keep me updated on the progress.

Regards,

Mubarak Kazan  
NMB Resident  
"A City Where People Care"



---

**From:** Scott, Esmond <[Esmond.Scott@citynmb.com](mailto:Esmond.Scott@citynmb.com)>

**Sent:** Tuesday, May 29, 2018 5:04 PM

**To:** M Kazan

**Cc:** Garcia, Ana; NMBMGR; Sosa-Cruz, Candido; Prescott, Kevin; Hernandez, William; Johnson, Judeen; Rodriguez, Fernando

**Subject:** RE: Re: 12th Ave thoroughfare needs permanent speed deterrents

Mr. Kazan:

Good afternoon.

In reviewing your concern, and as stated by DCM Sosa-Cruz, we will meet internally to discuss speeding and other deterrents.

I think it is imperative to apprise you however that the deterrents you proposed – all excellent traffic calming efforts – are not within our direct purview. Miami Dade County holds jurisdiction of NE 12<sup>th</sup> Avenue up to NE 151 Street, which is our city limit, and beyond to NE 149 Street.

There are strict traffic engineering guidelines that govern all traffic modifications and they all rest with, and are approved by Miami Dade County. I will forward this concern to the County in an effort to begin dialogue.

Best Regards,  
Esmond



Esmond K. Scott | Assistant City Manager

## FW: 12th Ave thoroughfare needs permanent speed deterrents

Johnson, Judeen <Judeen.Johnson@citynmb.com>

Wed 2/16/2022 2:28 PM

To: LaKeesha Morris-Moreau <LaKeesha@belltowergroup.org>; Tobias,Chidi <chidi.tobias@citynmb.com>; Jackson, Lynnetta <lynnetta.jackson@citynmb.com>

**Regards,**

**Judeen Johnson** | *Director*

City of North Miami Beach

Public Works Department

**T** (305) 948-2925

**F** (305) 957-3502

---

**From:** M Kazan [mailto:mikazan@msn.com]

**Sent:** Wednesday, September 26, 2018 5:22 PM

**To:** Sosa-Cruz, Candido <Candido.Sosa-Cruz@citynmb.com>; Hernandez, William <William.Hernandez@nmbpd.org>; Prescott, Kevin <Kevin.Prescott@nmbpd.org>; Rodriguez, Fernando <Fernando.Rodriguez@citynmb.com>; Johnson, Judeen <Judeen.Johnson@citynmb.com>

**Cc:** Scott, Esmond <Esmond.Scott@citynmb.com>; NMBMGR <NMBMGR@citynmb.com>; Kazan-gm305 <mikazan305@gmail.com>; Henry, Andrea M. <Andrea.Henry@citynmb.com>; Jackson, Lynnetta <Lynnetta.Jackson@citynmb.com>; Martin, Maythe <Maythe.Martin@citynmb.com>

**Subject:** Re: 12th Ave thoroughfare needs permanent speed deterrents

Good afternoon Mr. Sosa-Cruz.

I am pleased to be appraised of the efforts being outlined and the follow up to take place to address the speeding along 12th. I also will continue to monitor the situation and the progress.

Thanking all involved.

Kind regards,

Mubarak Kazan

NMB Resident

"A City Where People Care"

---

**From:** Sosa-Cruz, Candido <[Candido.Sosa-Cruz@citynmb.com](mailto:Candido.Sosa-Cruz@citynmb.com)>

**Sent:** Wednesday, September 26, 2018 2:54 PM

**To:** M Kazan; Hernandez, William; Prescott, Kevin; Rodriguez, Fernando; Johnson, Judeen

**Cc:** Scott, Esmond; NMBMGR; Kazan-gm305; Henry, Andrea M.; Jackson, Lynnetta; Martin, Maythe

**Subject:** RE: 12th Ave thoroughfare needs permanent speed deterrents

Good afternoon Mr. Kazan:

Please see below responses from our Public Works and Police Department.

## PUBLIC WORKS DEPARTMENT:

- The section of NE 12<sup>th</sup> Avenue from 151<sup>st</sup> street to 163<sup>rd</sup> Street is not within the City's jurisdictional control. It is a Miami-Dade County (M-DC) roadway. We have reviewed the area along NE 12<sup>th</sup> Avenue and conferred with our traffic engineering consultant (Chen-Moore).
- Based on other similar roadways and observed practices, we are recommending installation of "Radar Speed Sign(s)". A few examples of this device, which are in use in Miami Shores (Biscayne Boulevard), Miami Beach (Alton Road). We are in communication with M-DC on this for their consideration, and will make all efforts to expedite their evaluation and approval process.

## POLICE DEPARTMENT:

- On May 30, 2018, a request was made to Miami-Dade Department of Transportation and Public Works to implement speed limit signs along NE 12 Avenue between NE 151 Streets & 159 Streets. Installation of speed limits signage was completed along NE 10 & NE 12 Avenues.
- On June 8, 2018 a request was created to evaluate the feasibility of providing a multi-way stop sign control at NE 12 Avenue between NE 151 Street and NE 159 Street. The results of this study have not been completed at this time.
- A request was also made to install traffic calming devices in the area of NE 12 Avenue. This is being handled by Judeen Johnson (Public Works), on how to proceed on this matter.
- From the beginning of May 2018-present, the traffic unit has been diligently enforcing traffic violation in this area. The traffic unit has responded twenty (21) times and written 67 traffic tickets and warnings along NE 12 Avenue.

Thank you,  
Candido

*Candido Sosa-Cruz, MBA  
Deputy City Manager*

*City of North Miami Beach  
17050 NE 19th Avenue  
North Miami Beach, FL 33162  
Ofc: 305-957-3605  
Fax: 305-957-3602  
Email: [candido.sosa-cruz@citynmb.com](mailto:candido.sosa-cruz@citynmb.com)*

***"Excellence is the result of caring more than others think is wise, risking more than others think is safe, dreaming more than others think is practical, and expecting more than others think is possible."***

---

**From:** M Kazan [<mailto:mikazan@msn.com>]  
**Sent:** Tuesday, September 25, 2018 8:00 AM  
**To:** Sosa-Cruz, Candido <[Candido.Sosa-Cruz@citynmb.com](mailto:Candido.Sosa-Cruz@citynmb.com)>; Prescott, Kevin <[Kevin.Prescott@nmbpd.org](mailto:Kevin.Prescott@nmbpd.org)>; Hernandez, William <[William.Hernandez@nmbpd.org](mailto:William.Hernandez@nmbpd.org)>  
**Cc:** Scott, Esmond <[Esmond.Scott@citynmb.com](mailto:Esmond.Scott@citynmb.com)>; NMBMGR <[NMBMGR@citynmb.com](mailto:NMBMGR@citynmb.com)>; Kazan-gm305 <[mikazan305@gmail.com](mailto:mikazan305@gmail.com)>  
**Subject:** Re: 12th Ave thoroughfare needs permanent speed deterrents

Good morning Mr. Sosa-Cruz.

Plot Date: 10/19/2021 3:53:20 PM Username: JHail Layout Name: C6.01  
 Folder Path: V:\Projects\2021\21-083-030 - NE 151st Street Roundabout\Design\CAD\Sheets  
 Filename: 083-030 Pavement Marking and Signage.dwg

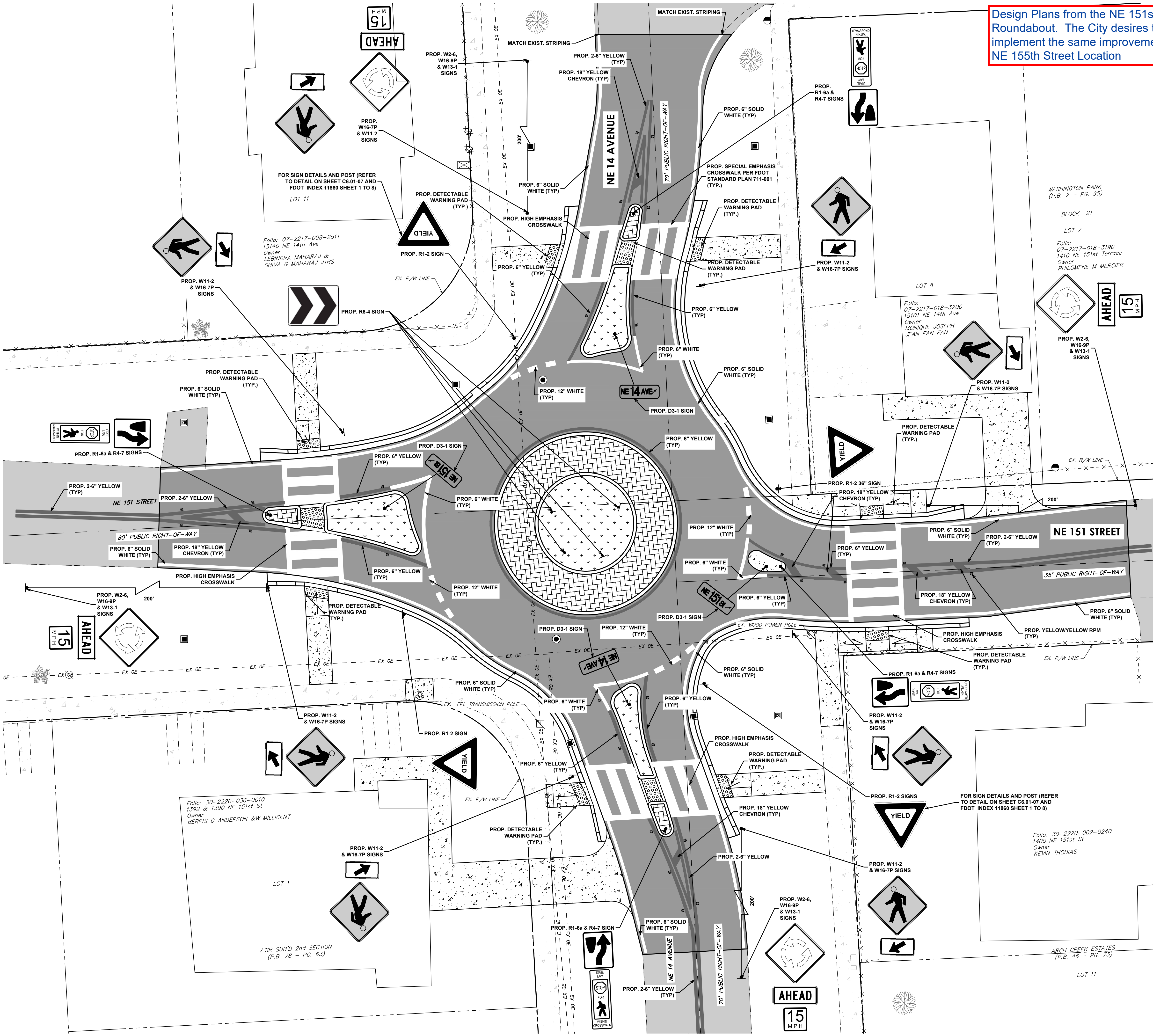

Design Plans from the NE 151st Street Roundabout. The City desires to implement the same improvements at the NE 155th Street Location

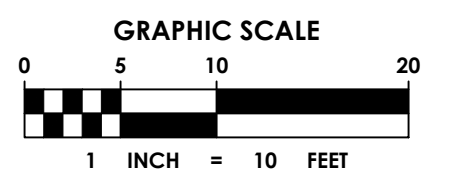

**LEGEND**

	RIGHT-OF-WAY LINE
	PARCEL BOUNDARY
	LOT OR PROPERTY LINE
	CENTER LINE
	EASEMENT LINE
	EXISTING CHAIN OR WIRE FENCE
	EXISTING OVERHEAD ELECTRIC
	EXISTING WATER MAIN
	EXISTING LOW PRESSURE FORCE MAIN
	EXISTING STORM DRAINAGE
	EXISTING CATCH BASIN
	EXISTING FIRE HYDRANT
	EXISTING WATER METER
	EXISTING GATE VALVE
	EXISTING ELEVATION
	EXISTING POWER POLE
	EXISTING LIGHT POLE
	EXISTING STREET SIGN POLE
	EXISTING HEDGE LINE
	EXISTING TREE
	PROP. TRAFFIC SIGN
	PROPOSED DETECTABLE WARNING SURFACE
	PROP. CATCH BASIN
	PROP. MANHOLE
	EX. CONC. SIDEWALK/DRIVEWAY
	PROP. CONC. SIDEWALK/DRIVEWAY
	EXISTING ASPHALT PAVEMENT
	PROPOSED ASPHALT PAVEMENT
	PROPOSED PAVERS
	PROPOSED SOD
	PROPOSED R.P.M.

**SIGNING AND MARKING NOTES:**

- ALL PAVEMENT MARKINGS SHALL BE THERMOPLASTIC UNLESS OTHERWISE NOTED.
- BI-DIRECTIONAL YELLOW/YELLOW REFLECTIVE PAVEMENT MARKERS SHALL BE PROVIDED AT 40' INTERVALS CENTERED BETWEEN YELLOW SKIP STRIPES.
- ONE BI-DIRECTIONAL YELLOW/YELLOW REFLECTIVE MARKER SHALL BE PROVIDED AT 40' INTERVALS ON EACH SIDE OF DOUBLE YELLOW STRIPES.
- ONE BI-DIRECTIONAL YELLOW/YELLOW REFLECTIVE PAVEMENT MARKER SHALL BE PROVIDED AT EACH END OF 18" YELLOW STRIPES ON EACH SIDE OF DOUBLE YELLOW STRIPES.
- BI-DIRECTIONAL COLORLESS/RED REFLECTIVE PAVEMENT MARKERS SHALL BE PROVIDED AT 20' INTERVALS ALONG SOLID WHITE LINES (NOT ON EDGE OF PAVEMENT LINES).
- BI-DIRECTIONAL YELLOW/YELLOW REFLECTIVE PAVEMENT MARKERS SHALL BE PROVIDED AT 1' INTERVALS AT ALL BULLNOSES.
- ALL SIGNING, PAVEMENT MARKINGS AND PLACEMENT OF REFLECTIVE PAVEMENT MARKERS SHALL CONFORM TO THE MANUAL OF UNIFORM TRAFFIC CONTROL DEVICES MANUAL (MUTCD), LATEST VERSION.
- ALL PAVEMENT MARKING SHALL BE HOT APPLIED THERMOPLASTIC MANUFACTURED AND APPLIED IN ACCORDANCE WITH FOOT STANDARD SPECIFICATION SECTION 711, LATEST EDITION.
- REFLECTIVE PAVEMENT MARKERS SHALL BE CLASS B MARKERS MANUFACTURED IN ACCORDANCE WITH FOOT STANDARD SPECIFICATION 706, LATEST EDITION AND INSTALLED IN ACCORDANCE WITH THE MANUFACTURER'S RECOMMENDED PROCEDURES.
- ALL SIGNS SHALL BE MANUFACTURED AND INSTALLED IN ACCORDANCE WITH THE MANUAL ON UNIFORM TRAFFIC CONTROL DEVICES, LATEST EDITION.
- ALL 'R1-1' & 'D3' SIGNS SHALL BE DIAMOND GRADE.
- THE PUBLIC ROADWAYS INDICATED IN THESE PLANS HAVE BEEN DESIGNED SUBSTANTIALLY IN ACCORDANCE WITH "THE MANUAL OF UNIFORM MINIMUM STANDARDS FOR DESIGN, CONSTRUCTION AND MAINTENANCE FOR STREETS AND HIGHWAYS-STATE OF FLORIDA". METHOD OF REMOVAL OF EXISTING PAVEMENT MARKINGS SHALL BE BY WATER JETTING OR SAND BLASTING.
- THE CONTRACTOR SHALL VERIFY PROPER STREET NAMES AND NUMBERS WITH AN APPROVED ADDRESS PLAN PRIOR TO ORDERING AND INSTALLING 'D3' SIGNS.

**EXISTING CONDITIONS PLAN:**

- EXISTING CONDITIONS PRESENTED ARE BASED ON A TOPOGRAPHIC SURVEY PROVIDED BY LONGITUDE SURVEYORS, PROJECT NO. 21243.0.01, DATED 06/09/2021. ADDITIONAL INFORMATION WAS OBTAINED FROM AS-BUILTS AND RECORD DRAWINGS PROVIDED BY UTILITY COMPANIES, G.I.S. INFORMATION AND FIELD VISITS.
- ALL ELEVATIONS ARE BASED ON THE NATIONAL GEODETIC VERTICAL DATUM OF 1929 (NGVD 29).
- NATIONAL GEODETIC SURVEY (NGS) BENCHMARK USED:  
 BENCHMARK 1  
 DESIGNATION = H-352  
 LOCATED = NE 149 ST -- 19' NORTH OF C/L AND NE 11 AVE -- 59' WEST OF C/L LOOKING NORTH  
 ELEVATION = 7.04' NGVD  
 BENCHMARK 2  
 DESIGNATION = N-758-R  
 LOCATED = NE 151 ST -- 31' NORTH OF C/L AND NE 12 AVE -- 31' WEST OF C/L  
 ELEVATION = 8.96' NGVD
- CONTRACTOR IS TO PROTECT ALL EXISTING TREES, SIGNS, AND ABOVE GROUND UTILITIES NOT IMPACTED BY THIS PLAN.

**Sunshine811**  
 Call 811 or www.sunshine811.com two full business days before digging to have utilities located and marked.  
 Check positive response codes before you dig!

**cma**  
 chen moore and associates  
 2103 Coral Way  
 Suite 401  
 Miami, FL 33145  
 786.497.1500  
 www.chenmoore.com

**REGISTRATION**  
 This item has been digitally signed and sealed by GREGORY A. MENDEZ, PE, on the date adjacent to the seal.  
 Printed copies of this document are not considered signed and sealed and the signature must be verified on any electronic copies.

GREGORY A. MENDEZ  
 LICENSE  
 No. 64718  
 STATE OF FLORIDA  
 PROFESSIONAL ENGINEER  
 SIGNATURE DATE: OCTOBER 19, 2021

**CLIENT**  
  
 CITY OF NORTH MIAMI BEACH  
 FLORIDA  
 THESE PEOPLE FIRST

**PROJECT INFORMATION**  
**NE 151ST STREET ROUNDABOUT**  
 NORTH MIAMI BEACH, FLORIDA 33162

**PROJECT NUMBER**  
 21-083.030

**CLIENT PROJECT NUMBER**  
 VERIFY SCALES  
 0 1" = 100'  
 IF NOT ONE INCH ON THIS SHEET, ADJUST SCALES ACCORDINGLY

**REVISIONS**

**DATE OF ISSUE**  
 10/19/2021  
**DESIGNED BY**  
 NSK  
**DRAWN BY**  
 AA  
**CHECKED BY**  
 GAM

**DRAWING TITLE**  
**PAVEMENT MARKING AND SIGNAGE PLAN**  
**DRAWING NUMBER**  
**C6.01**  
 7 OF 15

**PERMIT SET**



## City of North Miami Beach Previously Funded TAP Projects

Project Title	Contract #	Amount of Funding	Status of Project
CITYWIDE SIDEWALKS (VARIOUS LOCATIONS)	APM9100	\$108,290.00	Closed
CITYWIDE SIDEWALKS (VARIOUS LOCATIONS)	APM9101	\$4,000.00	Closed
NE 19 Ave from NE 171 St to NE 183 St.	APM9000	\$705,217.80	Closed
NE 19 Ave from NE 171 St to NE 183 St.	APM9001	\$55,188.00	Closed
NE 183 Bike Lane from NE 11 Ave to NE 19 Ave	19-050-MC	\$336,793.00	Closed